

LIMRA PROJECTS CONSULTANT

(A Unit of Limra Design Solutions)



LIMRA

LIMRA DESIGN SOLUTIONS

D-5, Okhla , New Delhi-110025

Mob : 9990736944, 8789159972

www.limradesign.com

E-mail : limradesignsolutions@gmail.com

ldsprojectsconsultant@gmail.com

EXPERTIES IN HOSPITAL EXPANSION & REMODELLING

E-mail IDs

Architect Division: limradesignsolutions@gmail.com
Technical Division: limradesignsolutionstech@gmail.com
Financial Division : ldsprojectsconsultant@gmail.com
Accreditation Division : limradesignsolutions@gmail.com



Cancer Hospital, Palwal, Haryana

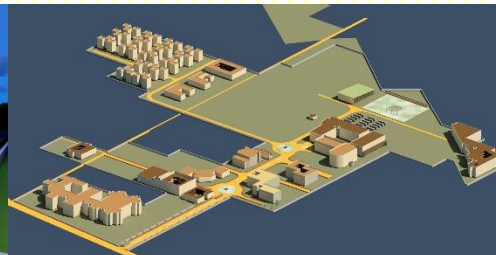

750 bedded Hospital at Faridabad, Haryana



Imam Bukhari Hospital at Kishanganj, Bihar



Silver crest hospital ,Ghaziipur, U.P



Vatharth hospital ,Noida, U.P



Hospital Block, Al-Falah University, Faridabad, Haryana

HEAD OFFICE: NEW DELHI

BRANCH OFFICE : | CHENNAI | PATNA | MEERUT | KISHANGANJ | SIWAN

AN OVER VIEW

Limra project consultants, working with a vision of "Healthcare for masses" is an umbrella firm of limra design solutions, which was established in 2010. The Limra project consultants (LPC) has been one of the leading project consultants in the field of health care architecture. LPC has a vast experience in setting -up, designing and construction of clinics, polyclinics, residence cum clinic, nursing homes, hospitals, specialty hospital, multi super specialty hospitals, medicity and mega hospitals of up to 2000 beds. LPC has specialty of hospital expansion, hospital adaptive reuse, departmental expansion and setting of latest facilities into existing hospital setup. LPC is platform of experienced and reputed consultants under one roof and is supported by a dedicated research wing of Healthcare Architecture

LPC has also expertise of setting up of educational institutions associated with hospitals like medical college, dental college, nursing college, physiotherapy college, pharmacy college, AYUSH Colleges and Para-medical colleges. The LPC's major work areas may be categories as below.

1. Preparation of vision, mission and policy document with DPR
2. Documentation for NOC, LOI, LOP for new hospitals
3. Planning and designing of hospitals
4. PMC for construction of new facility
5. Accreditation of hospitals
6. Green hospital approval
7. Hospital equipment planning
8. Hospital HR planning
9. Re- furnishing, Re branding, Adaptive re use
10. Hospital interiors under healing architecture

❖ TECHNICAL CONSULTANCY

- Technical consultancy for setting up the college and hospital as per norms OF MCI/DCI/INC and PCI and ministry of health and family welfare.
- Preparation of project report for state government N.O.C. (essentiality certificate)
- Preparation of project report for university N.O.C. (consent of affiliation)
- Preparation of project report for ministry of health & family welfare NMC/ MCI/DCI/INC / PCI/ AYUSH.
- Identification of equipments / instruments / furniture , etc.
- Identification of manpower as per norms of MCI/DCI/INC / other statutory councils
- Preparation of blood band report
- Preparation of BARC report for radio-diagnosis department
- Conduct of mock inspection to prepare for LOI/LOP inspection of MCI/DCI.
- Motivating the teaching and non-teaching faculty
- Setting up urban health centre
- Setting up rural / primary health centre (PHC's,), Community Health Centers (CHC's)
- Monitoring medical records
- Assistance in providing required information to the management for furnishing LOI & LOP documents for medical college/ dental college.

ESTABLISHMENT OF HEALTH SCIENCE INSTITUTIONS

- Medical College & Hospital
- Dental College
- Super Specialty Hospital
- Nursing Home / Dispensaries
- Nursing College
- Physiotherapy College
- Paramedical College
- Ayurvedic College
- Homeopathy College
- Unani College
- Siddha College
- Naturopathy & Yogic Sciences
- Acupuncture Therapy Centre

IT CONSULTANCY

- ERP and Software
- Website Development

LIST OF HEALTHCARE PROJECTS	
GENERAL HOSPITAL (30, 50, 100, 150,200,300,500,900 BEDS)	
SPECIALITY HOSPITAL (30, 50, 100, 150,200,300,500,900 BEDS) (CARDIAC, EYE, PAEDIATRICS, ORTHOPEDICS, NEUROLOGY, CANCER, TB, PSYCHIATRY, GYNAECOLOGY, BURN)	
MULTI SPECIALITY HOSPITAL (30, 50, 100, 150,200,300,500,900 BEDS)	
SUPER SPECIALITY HOSPITAL (30, 50, 100, 150,200,300,500,900 BEDS)	
AYUSH, HOSPITALS	
DIABETOLOGY INSTITUTE	
MEDICAL WASTE MANAGEMENT	
EYE HOSPITAL	
ONCOLOGY CENTRE	
VOCATIONAL REHABILITATION & TRAINING CENTRE FOR DIFFERENTLY ABLE	
CARDIAC HOSPITAL	
NATURAL VENTILATION IN HOSPITAL BUILDING	
PLANNING & FUNCTIONING OF OPERATION THEATRE	
MEDICITY	
DISTRICT HOSPITAL	
SUPER SPECIALTY HOSPITALS	
MULTISPECIALITY HOSPITALS	
SPACE STANDARDS OF NATUROPATHY AND YOGIC SCIENCE	
HVAC ,STRUCTURE DESIGN , ELECTRICAL, PLUMBING, MGPS, RO SYSTEM, STP, ETP IN HOSPITAL	
HOSPITAL HEALING ENVIRONMENT	
MENTAL HEALTHCARE HOSPITAL	
MATERNITY AND PEDIATRIC HOSPITAL	
BLOOD BANK, CSSD, LAUNDRY, MORTURY.	
TRAUMA CENTRE	
NURSING HOMES	
CLINICS (TYPE-I, II, III)	
POLYCLINICS (TYPE-I, II, III)	
DIAGNOSTIC CENTRES	
DENTAL SCIENCE HOSPITAL	
HOSPICE	
HOSPITAL EXPANSION, REMODELLING OF HOSPITAL, EXPANSION OF DEPARTMENTS	

PATRON



AR. V.K JAIN
Fellow Architect



PROF. K.K MITRA
Former Chief Architect
MES (Military Engg. Services)



PROF. DIVYA KUSH
Former President
Indian Institute of Architects
IIA, India

CONSULTANTS



ER.A.C VERMA
MEP consultant



ER. F. BARI
Structural consultant



DR. BHARBI
NABH Accessor
Hospital Consultant



ASHKAR HASHMI
Director
Project management



SHAMSHAD KHAN
Fire Fighting
Consultant



AFZAL ALAM
IT Head

TEAM MEMBERS



AR. MD. SHAHROZ
ALAM
Senior planner



AR. MD. SAJID SAIFI
Interior & Façade
Consultant



AR. AFTAB ALAM
Healthcare Architect



ER.ALI
Project manager



AR.MAK
Healthcare researcher



AR.NOOR ALAM
CHOUHARY
Senior
Healthcare architect



AR.NAWAZISH ANSARI



AR. MD. ATIQUE



AR. SUMIT BHARGAV



AR. SHIV



AR. HRITURAJ MISHRA



AR. ASAF

ADDRESS :

D-5, Okhla , New Delhi-110025

Mob : 9990736944, 8789159972

E-mail : limradesignsolutions@gmail.com, ldsprojectsconsultant@gmail.com,

Website : www.limrdesign.com